

# \$23,550 - E E Avenue U4, Pearblossom

MLS® #IV25039072

---

**\$23,550**

0 Bedroom, 0.00 Bathroom,  
Land on 5 Acres

N/A, Pearblossom,

APN: 3039-024-031 Coordinates: 34.524389,  
-117.881333 5 Acres for sale in LA county.  
This parcel is located in Pearblossom, CA.  
Excellent location nor far off of HWY 138. This  
area is a growing rural community in the  
Antelope Valley with stores and restaurants  
near by in Pearblossom.

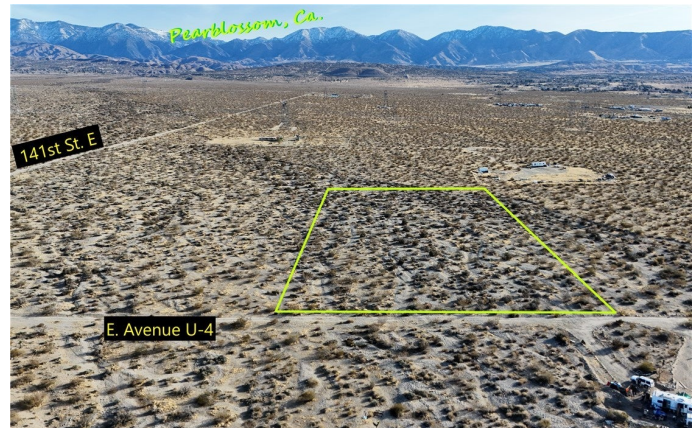

## Essential Information

MLS® #	IV25039072
Price	\$23,550
Bathrooms	0.00
Acres	5.01
Type	Land
Status	Closed
Listing Agent	Nydia Del Rio
Listing Office	HOME & LAND SOURCE

## Community Information

Address	E E Avenue U4
Area	PBLM - Pearblossom
Subdivision	N/A
City	Pearblossom
County	Los Angeles
Zip Code	93553

## Amenities

Utilities	Water Not Available
View	Desert, Hills, Mountain(s)

**Exterior**

Lot Description        Agricultural

**Additional Information**

Date Listed            February 21st, 2025  
Days on Market        290  
Zoning                 LCA25\*  
Short Sale             N  
RE / Bank Owned     N

Based on information from California Regional Multiple Listing Service, Inc. as of February 2nd, 2026 at 7:45pm PST. This information is for your personal, non-commercial use and may not be used for any purpose other than to identify prospective properties you may be interested in purchasing. Display of MLS data is usually deemed reliable but is NOT guaranteed accurate by the MLS. Buyers are responsible for verifying the accuracy of all information and should investigate the data themselves or retain appropriate professionals. Information from sources other than the Listing Agent may have been included in the MLS data. Unless otherwise specified in writing, Broker/Agent has not and will not verify any information obtained from other sources. The Broker/Agent providing the information contained herein may or may not have been the Listing and/or Selling Agent.