

\$59,000 - 150 Ste Vic Ave N 4 Ste Street, Palmdale

MLS® #BB25178569

\$59,000

0 Bedroom, 0.00 Bathroom,
Land on 10 Acres

N/A, Palmdale,

Nearly 10 acres available in the thriving Palmdale-Lancaster area, one of Southern California's fastest-growing hubs. With flat terrain and light industrial zoning, this property is ideal for development, investment or a private retreat. Palmdale and Lancaster are known for their booming aerospace industry, home to major employers like Lockheed Martin, Boeing, and Northrop Grumman. The area offers a vibrant lifestyle with attractions such as Lancaster's Boulevard district, the Palmdale Amphitheater, and DryTown Water Park. Conveniently located near Palmdale's local Airport and major highways, this lot provides easy access to key destinations. Nature and history lovers will appreciate nearby landmarks like Big Rock Wash Wildlife Sanctuary, the Antelope Valley Indian Museum, Edwards Air Force Base, and the stunning California Poppy Reserve. Located near a paved road, this property is ready for your vision. Come explore the possibilities to invest in a fast-growing region! Seller financing considered.

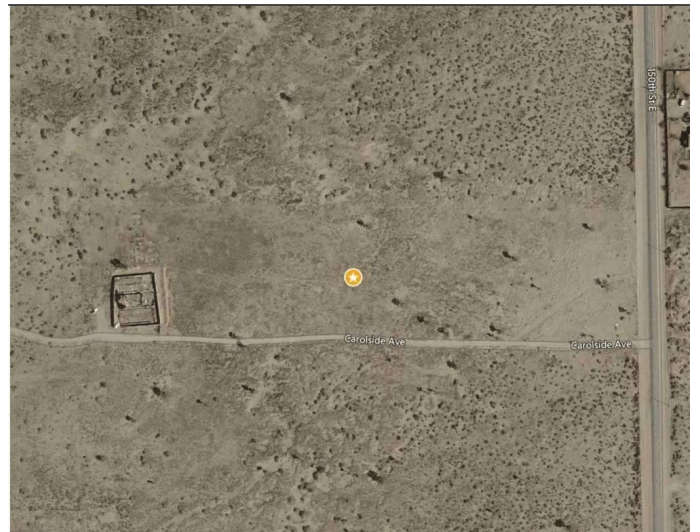

Essential Information

MLS® #	BB25178569
Price	\$59,000
Bathrooms	0.00
Acres	9.99
Type	Land

Status	Closed
Listing Agent	Milla Goldenberg
Listing Office	Judy Graff Properties

Community Information

Address	150 Ste Vic Ave N 4 Ste Street
Area	PLM - Palmdale
Subdivision	N/A
City	Palmdale
County	Los Angeles
Zip Code	93591

Amenities

View	Desert
------	--------

Exterior

Lot Description	SixToTenUnitsAcre
-----------------	-------------------

Additional Information

Date Listed	August 7th, 2025
Days on Market	5
Zoning	LCA11*
Short Sale	N
RE / Bank Owned	N

Based on information from California Regional Multiple Listing Service, Inc. as of January 22nd, 2026 at 5:26am PST. This information is for your personal, non-commercial use and may not be used for any purpose other than to identify prospective properties you may be interested in purchasing. Display of MLS data is usually deemed reliable but is NOT guaranteed accurate by the MLS. Buyers are responsible for verifying the accuracy of all information and should investigate the data themselves or retain appropriate professionals. Information from sources other than the Listing Agent may have been included in the MLS data. Unless otherwise specified in writing, Broker/Agent has not and will not verify any information obtained from other sources. The Broker/Agent providing the information contained herein may or may not have been the Listing and/or Selling Agent.