

\$799,000 - 350 N Clybourn Avenue # 36, Burbank

MLS® #26640607

\$799,000

2 Bedroom, 2.00 Bathroom, 975 sqft
Residential on 1 Acres

N/A, Burbank,

Enjoy effortless CALIFORNIA LIVING in this striking MOVE-IN READY, END-UNIT TOWNHOUSE that lives like a SINGLE-FAMILY home, complete with a PRIVATE DIRECT-ACCESS 2-car garage & LARGE OUTDOOR PATIO fusing the indoor and outdoor space seamlessly. Enjoy a RESORT-STYLE community POOL & EXTENSIVE SYSTEM UPGRADES, including a 2025 ROOF replacement, NEW INTERIOR PAINT, upgraded lighting & electrical, COPPER PLUMBING, sewer replacement, new low-maintenance landscaping, UPDATED BATHROOMS & WOOD FLOORS throughout. Ideally situated near TOLUCA LAKE VILLAGE & all that Burbank has to offer...TOP-RATED SCHOOLS, major STUDIOS, SHOPPING, and services, with close, CAR-OPTIONAL access to grocery stores & FINE & CASUAL DINING, plus convenient freeway connections. A RARE OPPORTUNITY to enjoy iconic design, MODERN UPGRADES, PLENTIFUL STORAGE and an UNBEATABLE LOCATION-all at EXCEPTIONAL ENTRY-LEVEL PRICING.

Built in 1964

Essential Information

MLS® #	26640607
Price	\$799,000
Bedrooms	2

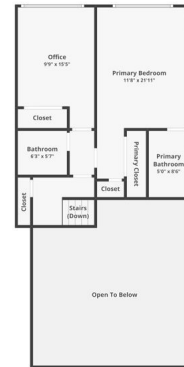

350 N Clybourn Ave, Burbank, CA 91505
Floor 2

Floor plan/visual cannot be used for building or design purposes. Sizes and dimensions are approximate.

Bathrooms	2.00
Full Baths	2
Square Footage	975
Acres	1.32
Year Built	1964
Type	Residential
Sub-Type	Townhouse
Style	Mid-Century Modern
Status	Closed
Listing Agent	Tina Smith
Listing Office	Sotheby's International Realty

Community Information

Address	350 N Clybourn Avenue # 36
Area	610 - Burbank
Subdivision	N/A
City	Burbank
County	Los Angeles
Zip Code	91505

Amenities

Amenities	Pool
Parking	Door-Multi, Direct Access, Garage, Garage Door Opener
# of Garages	2
Garages	Door-Multi, Direct Access, Garage, Garage Door Opener
View	Mountain(s)
Has Pool	Yes
Pool	Community, Association

Interior

Interior	Tile, Wood
Interior Features	Breakfast Bar, Ceiling Fan(s), Separate/Formal Dining Room, Open Floorplan
Appliances	Dishwasher, Disposal, Microwave
Heating	Central
Cooling	Central Air
Fireplaces	None
Stories	Multi/Split

Additional Information

Date Listed	January 21st, 2026
Days on Market	39
Zoning	BUR4*
Short Sale	N
RE / Bank Owned	N

Based on information from California Regional Multiple Listing Service, Inc. as of April 15th, 2026 at 9:58pm PDT. This information is for your personal, non-commercial use and may not be used for any purpose other than to identify prospective properties you may be interested in purchasing. Display of MLS data is usually deemed reliable but is NOT guaranteed accurate by the MLS. Buyers are responsible for verifying the accuracy of all information and should investigate the data themselves or retain appropriate professionals. Information from sources other than the Listing Agent may have been included in the MLS data. Unless otherwise specified in writing, Broker/Agent has not and will not verify any information obtained from other sources. The Broker/Agent providing the information contained herein may or may not have been the Listing and/or Selling Agent.