

\$3,295,000 - 251 Ashdale Avenue, Los Angeles

MLS® #25583177

\$3,295,000

4 Bedroom, 4.00 Bathroom, 2,595 sqft
Residential on 0 Acres

N/A, Los Angeles,

Nestled in lower Bel-Air just north of Sunset, this beautifully remodeled Mid-Century single-level residence sits elevated from the street, capturing dramatic sweeping city views and provides for privacy. Offering 4 bedrooms and 3.5 baths, the home is move-in ready with an ideal floor plan. The spacious primary suite features a walk-in closet and en suite bath and opens to private patio with hot tub. Adjacent to the primary suite are two additional bedrooms that share a hall bath. On the other side of the home is a separate maid's room/guest suite or office with en-suite bath and conveniently located off the kitchen. Designed for both comfort and entertaining, the open living and dining areas overlook stunning views, while the remodeled kitchen flows seamlessly into the family room with fireplace. The home has 2 zone HVAC, security systems and skylights. The private backyard with built BBQ is perfect for gatherings, with ample space for outdoor living and entertaining. Located in a coveted Bel-Air location. This is a rare offering.

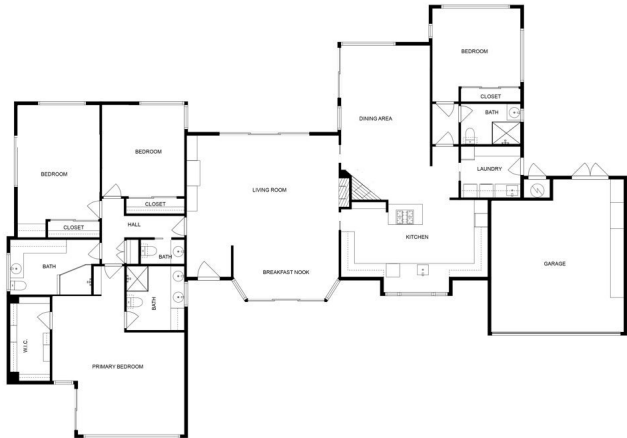

MEASUREMENTS ARE CALCULATED BY SCANNING TECHNOLOGY. DEEMED HIGHLY RELIABLE BUT NOT GUARANTEED.

Built in 1953

Essential Information

MLS® #	25583177
Price	\$3,295,000
Bedrooms	4
Bathrooms	4.00
Half Baths	1

Square Footage	2,595
Acres	0.30
Year Built	1953
Type	Residential
Sub-Type	Single Family Residence
Style	Mid-Century Modern
Status	Closed
Listing Agent	Steven Moritz
Listing Office	Sotheby's International Realty

Community Information

Address	251 Ashdale Avenue
Area	C04 - Bel Air - Holmby Hills
Subdivision	N/A
City	Los Angeles
County	Los Angeles
Zip Code	90049

Amenities

Parking Spaces	5
Parking	Door-Multi, Driveway, Garage, Garage Door Opener, On Street, Side By Side, Driveway Down Slope From Street
# of Garages	2
Garages	Door-Multi, Driveway, Garage, Garage Door Opener, On Street, Side By Side, Driveway Down Slope From Street
View	City Lights
Pool	None
Security	Carbon Monoxide Detector(s), Smoke Detector(s)

Exterior

Exterior Features	Rain Gutters
Lot Description	Back Yard, Landscaped
Roof	Composition

Interior

Interior	Carpet, Tile
Interior Features	Breakfast Bar, Separate/Formal Dining Room, Utility Room, Walk-In Closet(s)
Appliances	Barbecue, Double Oven, Dishwasher, Gas Cooktop, Disposal, Microwave, Refrigerator, Dryer, Washer

Heating	Central
Fireplace	Yes
Fireplaces	Family Room, Living Room
# of Stories	1
Stories	One

Additional Information

Date Listed	September 18th, 2025
Days on Market	7
Zoning	LARE15
Short Sale	N
RE / Bank Owned	N

Based on information from California Regional Multiple Listing Service, Inc. as of January 2nd, 2026 at 3:30am PST. This information is for your personal, non-commercial use and may not be used for any purpose other than to identify prospective properties you may be interested in purchasing. Display of MLS data is usually deemed reliable but is NOT guaranteed accurate by the MLS. Buyers are responsible for verifying the accuracy of all information and should investigate the data themselves or retain appropriate professionals. Information from sources other than the Listing Agent may have been included in the MLS data. Unless otherwise specified in writing, Broker/Agent has not and will not verify any information obtained from other sources. The Broker/Agent providing the information contained herein may or may not have been the Listing and/or Selling Agent.