

# \$1,595,000 - 1035 Hartzell Street, Pacific Palisades

MLS® #25557285

## \$1,595,000

0 Bedroom, 0.00 Bathroom,  
Land on 0 Acres

N/A, Pacific Palisades,

Build Your Dream Home in Pacific Palisades. 1035 Hartzell Street presents a rare opportunity to build new construction in the desirable Alphabet Streets neighborhood of Pacific Palisades. Located in the heart of the neighborhood, the location offers convenient access to Palisades Village, shopping, dining, and nearby recreation facilities soon to be revitalized, while still offering a peaceful residential setting. This charming, community-oriented neighborhood is undergoing a thoughtful transformation. A recent poll of "Alphabet" homeowners revealed that 70% plan to rebuild. With new construction already underway, this is an exciting time to join the Palisades revitalization. 1035 has been professionally cleared by the Army Corps of Engineers. Soil testing by the Clean Soil Project at USC confirmed that lead levels are safely below EPA safety standards and well under the toxic threshold. The previous structure was a 1,080 square foot (per public record) 1947 original home.

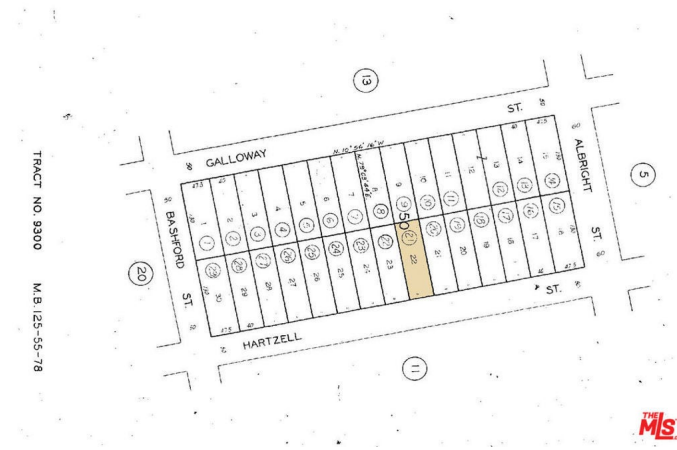

## Essential Information

MLS® #	25557285
Price	\$1,595,000
Bathrooms	0.00
Acres	0.12
Type	Land

Status	Closed
Listing Agent	Joy Lizabeth Kelly
Listing Office	Sotheby's International Realty

### **Community Information**

Address	1035 Hartzell Street
Area	C15 - Pacific Palisades
Subdivision	N/A
City	Pacific Palisades
County	Los Angeles
Zip Code	90272

### **Amenities**

View	None
------	------

### **Exterior**

Lot Description	Flat
-----------------	------

### **Additional Information**

Date Listed	June 27th, 2025
Days on Market	12
Zoning	LAR1
Short Sale	N
RE / Bank Owned	N

Based on information from California Regional Multiple Listing Service, Inc. as of April 10th, 2026 at 7:45am PDT. This information is for your personal, non-commercial use and may not be used for any purpose other than to identify prospective properties you may be interested in purchasing. Display of MLS data is usually deemed reliable but is NOT guaranteed accurate by the MLS. Buyers are responsible for verifying the accuracy of all information and should investigate the data themselves or retain appropriate professionals. Information from sources other than the Listing Agent may have been included in the MLS data. Unless otherwise specified in writing, Broker/Agent has not and will not verify any information obtained from other sources. The Broker/Agent providing the information contained herein may or may not have been the Listing and/or Selling Agent.