

\$1,695,000 - 700 Haverford Avenue, Pacific Palisades

MLS® #25514737

\$1,695,000

0 Bedroom, 0.00 Bathroom,
Land on 0 Acres

N/A, Pacific Palisades,

Set in the heart of the Palisades Village on Haverford Avenue, this lot offers a chance to call one of the Palisades' best neighborhoods home. Just moments from the beach, PCH, and Temescal Gateway Park. EPA Phase 1 is complete. Seller has registered for Phase 2 (debris removal).

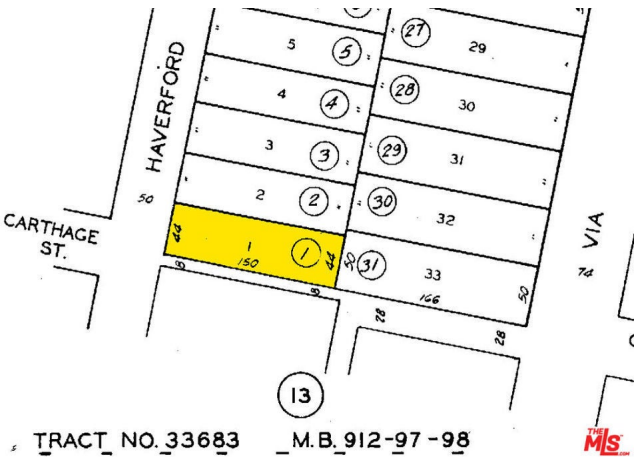

Essential Information

MLS® #	25514737
Price	\$1,695,000
Bathrooms	0.00
Acres	0.15
Type	Land
Status	Closed
Listing Agent	Dan Urbach
Listing Office	Compass

Community Information

Address	700 Haverford Avenue
Area	C15 - Pacific Palisades
Subdivision	N/A
City	Pacific Palisades
County	Los Angeles
Zip Code	90272

Amenities

View	None
------	------

Additional Information

Date Listed	March 21st, 2025
Days on Market	4
Zoning	LAR1
Short Sale	N
RE / Bank Owned	N

Based on information from California Regional Multiple Listing Service, Inc. as of December 21st, 2025 at 12:26pm PST. This information is for your personal, non-commercial use and may not be used for any purpose other than to identify prospective properties you may be interested in purchasing. Display of MLS data is usually deemed reliable but is NOT guaranteed accurate by the MLS. Buyers are responsible for verifying the accuracy of all information and should investigate the data themselves or retain appropriate professionals. Information from sources other than the Listing Agent may have been included in the MLS data. Unless otherwise specified in writing, Broker/Agent has not and will not verify any information obtained from other sources. The Broker/Agent providing the information contained herein may or may not have been the Listing and/or Selling Agent.